

SC.. PCLNR/L

95°

NEW

DISPONIBILE DA AGOSTO 2014
 AVAILABLE FROM AUGUST 2014
 AB AUGUST 2014 LIEFERBAR
 DISPONIBLE À PARTIR DE AOÛT 2014

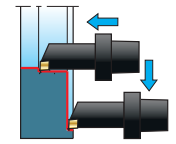
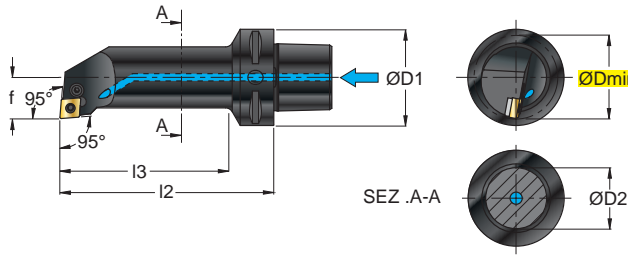

CNMA	
CNMG	
CNMM	

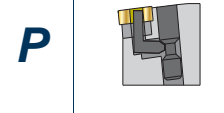

in figura utensile destro - right-hand shown

																		INSERTI - INSERTS PAG. A 133							
ART.																									
											(mm)														
											ØDmin	ØD1	ØD2	f	l2	l3									
SC40 PCLNR/L 22110-12	PSC40										39	40	32	22	110	87	1204	8012	1608	5003	3612	4112	0012		
SC50 PCLNR/L 22110-12	PSC50										39	50	32	22	110	87									
SC63 PCLNR/L 27140-12	PSC63										48	63	40	27	140	111									

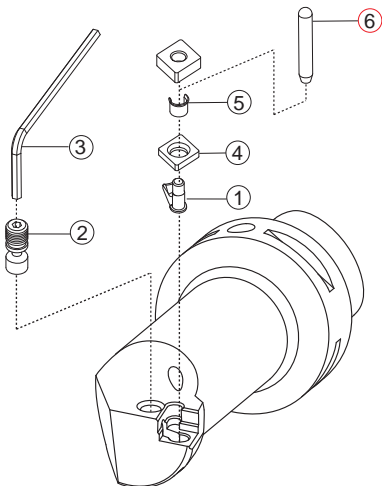

CAMPI D'IMPIEGO DEGLI INSERTI PER TORNITURA
 FIELDS OF APPLICATION FOR TURNING INSERTS
 EINSATZGEBIETE FÜR DREHPLATTEN
 CHAMPS D'USINAGE DES PLAQUETTES POUR TORNAGE

PAG. A 126

VELOCITÀ DI TAGLIO Vc
 Vc. CUTTING SPEED
 Vc. SCHNITTGESCHWINDIGKEIT
 Vc. VITESSE DE COUPE

Vc **PAG. A 124**

DETTAGLIO RICAMBI
 SPARE PARTS DETAILS
 DETAILS ZU DEN ERSATZTEILEN
 DÉTAIL DE PIÈCES DE RECHANGE

PAG. G 1

DATI TECNICI E CONSIGLI
 TECHNICAL DATA AND SUGGESTIONS
 TECHNISCHE DATEN UND EMPFEHLUNGEN
 DONNÉES TECHNIQUES ET CONSEILS

PAG. H 2

SC.. PWLNR/L

95°

NEW

DISPONIBILE DA AGOSTO 2014
 AVAILABLE FROM AUGUST 2014
 AB AUGUST 2014 LIEFERBAR
 DISPONIBLE À PARTIR DE AOÛT 2014

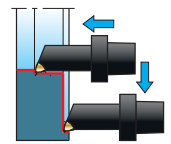
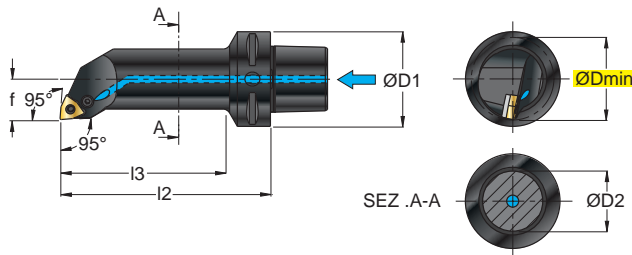

WNMA	
WNMG	
WNMM	

P



In figura utensile destro - Right-hand shown



INSERTI - INSERTS
 PAG. A 137

ART.	L R	PSC (mm)	ØDmin	ØD1	ØD2	f	l2	l3	0804	1	2	3	4	5	6
SC40 PWLNR/L 22110-08		PSC40	39	40	32	22	110	87		8012	1608	5003	3308M	4112	0012
SC50 PWLNR/L 22110-08		PSC50	39	50	32	22	110	87							
SC63 PWLNR/L 27140-08		PSC63	48	63	40	27	140	111							

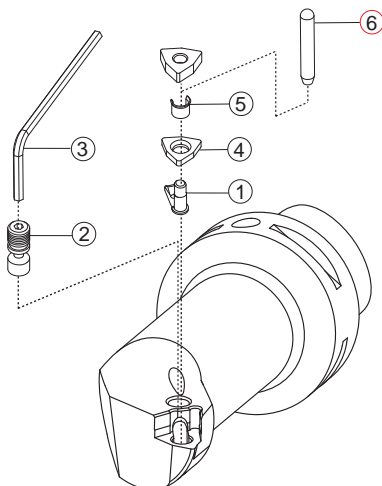

CAMPI D'IMPIEGO DEGLI INSERTI PER TORNITURA
 FIELDS OF APPLICATION FOR TURNING INSERTS
 EINSATZGEBIETE FÜR DREHPLATTEN
 CHAMPS D'USINAGE DES PLAQUETTES POUR TOURNAGE

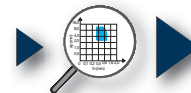

PAG. A 126

VELOCITÀ DI TAGLIO Vc
 Vc. CUTTING SPEED
 Vc. SCHNITTGESCHWINDIGKEIT
 Vc. VITESSE DE COUPE



PAG. A 124

DETTAGLIO RICAMBI
 SPARE PARTS DETAILS
 DETAILS ZU DEN ERSATZTEILEN
 DÉTAIL DE PIÈCES DE RECHANGE



PAG. G 1

DATI TECNICI E CONSIGLI
 TECHNICAL DATA AND SUGGESTIONS
 TECHNISCHE DATEN UND EMPFEHLUNGEN
 DONNÉES TECHNIQUES ET CONSEILS



PAG. H 2

SC.. SDUCR/L

93°

NEW

DISPONIBILE DA AGOSTO 2014
 AVAILABLE FROM AUGUST 2014
 AB AUGUST 2014 LIEFERBAR
 DISPONIBLE À PARTIR DE AOÛT 2014

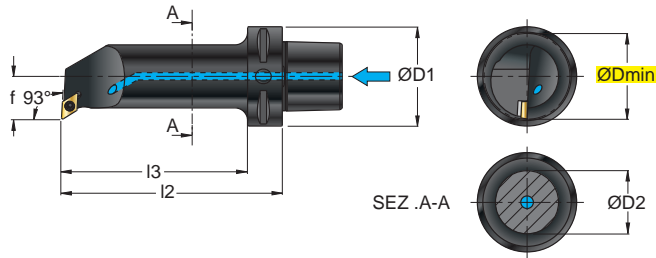
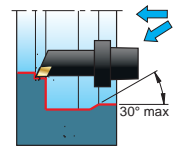

DC.T



DC.W



S



in figura utensile destro - right-hand shown

											INSERTI - INSERTS PAG. A 140					
											1	2	2	4	⊙	
ART.	(mm)															
				ØDmin	ØD1	ØD2	f	I2	I3	Nm						
SC40 SDUCR/L 17090-11				PSC40	30	40	25	17	90	68	3,0÷3,5	11T3	—	—	1240P	5515P
SC40 SDUCR/L 22110-11				PSC40	39	40	32	22	110	87	3,0÷3,5	11T3	3711	BCL7	123511P	5515P
SC50 SDUCR/L 17090-11				PSC50	30	50	25	17	90	68	3,0÷3,5	11T3	—	—	1240P	5515P
SC50 SDUCR/L 22110-11				PSC50	39	50	32	22	110	87	3,0÷3,5	11T3	3711	BCL7	123511P	5515P
SC63 SDUCR/L 22125-11				PSC63	39	63	32	22	125	102	3,0÷3,5					
SC63 SDUCR/L 22160-11				PSC63	39	63	32	22	160	132	3,0÷3,5					
SC63 SDUCR/L 27140-11				PSC63	48	63	40	27	140	111	3,0÷3,5					
SC63 SDUCR/L 27180-11				PSC63	48	63	40	27	180	151	3,0÷3,5					

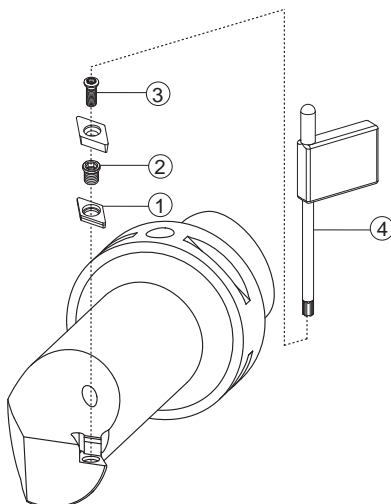

CAMPI D'IMPIEGO DEGLI INSERTI PER TORNITURA
 FIELDS OF APPLICATION FOR TURNING INSERTS
 EINSATZGEBIETE FÜR DREHPLATTEN
 CHAMPS D'USINAGE DES PLAQUETTES POUR TOURNAGE

VELOCITÀ DI TAGLIO Vc
 Vc. CUTTING SPEED
 Vc. SCHNITTGESCHWINDIGKEIT
 Vc. VITESSE DE COUPE

DETTAGLIO RICAMBI
 SPARE PARTS DETAILS
 DETAILS ZU DEN ERSATZTEILEN
 DÉTAIL DE PIÈCES DE RECHANGE

DATI TECNICI E CONSIGLI
 TECHNICAL DATA AND SUGGESTIONS
 TECHNISCHE DATEN UND EMPFEHLUNGEN
 DONNÉES TECHNIQUES ET CONSEILS

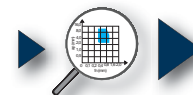

PAG. A 126



PAG. A 124



PAG. G 1



PAG. H 2

SC.. SVQBR/L

107,5°

NEW

DISPONIBILE DA AGOSTO 2014
AVAILABLE FROM AUGUST 2014
AB AUGUST 2014 LIEFERBAR
DISPONIBLE À PARTIR DE AOÛT 2014

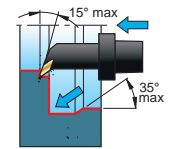
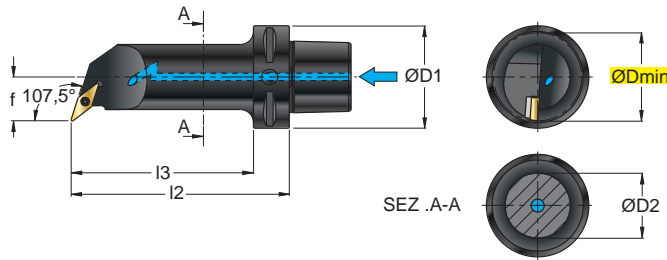

VB.T



VB.W



S



In figura utensile destro - Right-hand shown



.B36 .S42 .B58

INSERTI - INSERTS
PAG. A 143

ART.	 (mm)	 ØDmin	ØD1	ØD2	f	I2	I3	Nm		1	2	3	4	
SC50 SVQBR/L 17090-16	PSC50	30	50	25	17	90	65	3,0÷3,5	1604	—	—	123509P	5515P	
SC63 SVQBR/L 22125-16	PSC63	39	63	32	22	125	95	3,0÷3,5	1604	3716	BCL7	123511P	5515P	
SC63 SVQBR/L 27180-16	PSC63	48	63	40	27	180	150	3,0÷3,5						

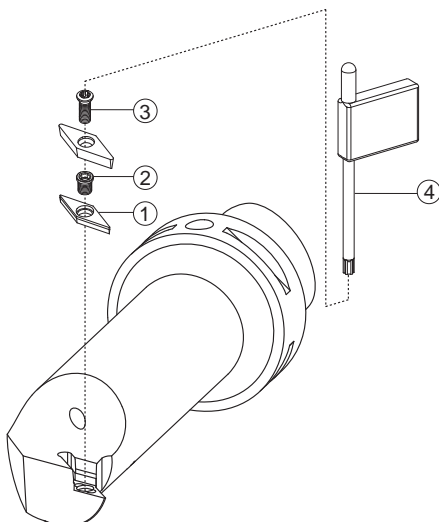

CAMPI D'IMPIEGO DEGLI INSERTI PER TORNITURA
 FIELDS OF APPLICATION FOR TURNING INSERTS
 EINSATZGEBIETE FÜR DREHPLATTEN
 CHAMPS D'USINAGE DES PLAQUETTES POUR Tournage



PAG. A 126

VELOCITÀ DI TAGLIO Vc
 Vc. CUTTING SPEED
 Vc. SCHNITTGESCHWINDIGKEIT
 Vc. VITESSE DE COUPE



PAG. A 124

DETTAGLIO RICAMBI
 SPARE PARTS DETAILS
 DETAILS ZU DEN ERSATZTEILEN
 DÉTAIL DE PIÈCES DE RECHANGE



PAG. G 1

DATI TECNICI E CONSIGLI
 TECHNICAL DATA AND SUGGESTIONS
 TECHNISCHE DATEN UND EMPFEHLUNGEN
 DONNÉES TECHNIQUES ET CONSEILS



PAG. H 2