

**ART. HSK. ..C..  
HSK - AD (DIN 69893)**

**NEW**

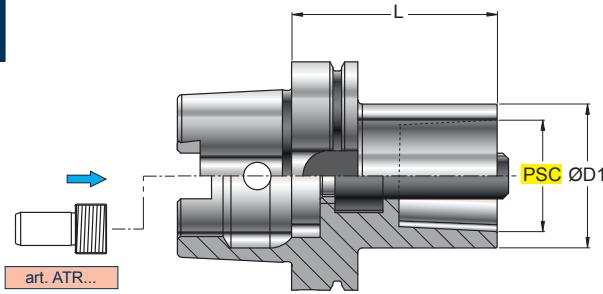

ADATTATORE BASE  
BASIC ADAPTER  
GRUNDAUFNAHMEN  
ADAPTATEUR BASIQUE

PRE-EQUILBRATO PRE-BALANCED  
G 6,3 8000 min-1

ART.		(mm)							
		PSC	ØD1	L					
HSK.063.C63.110	HSK63	PSC63	63	110					
HSK.100.C63.090	HSK100	PSC63	63	090					
HSK.100.C63.150	HSK100	PSC63	63	150					

**ART. 370.3..C..  
DIN 69871/AD-B**

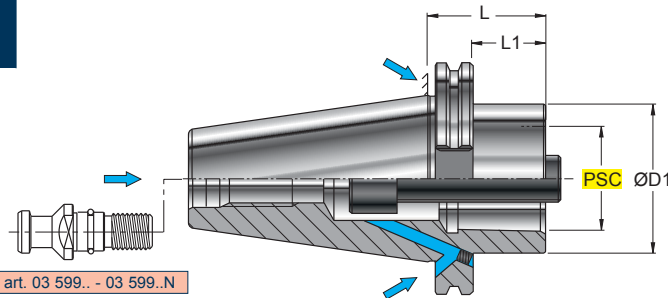

ADATTATORE BASE  
BASIC ADAPTER  
GRUNDAUFNAHMEN  
ADAPTATEUR BASIQUE

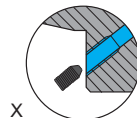

PRE-EQUILBRATO PRE-BALANCED  
G 6,3 8000 min-1

ART.		(mm)								
		PSC	ØD1	L	L1					
370.340.C63.030	New	ISO40	PSC40	40	30	10,9				
370.350.C63.030	New	ISO50	PSC40	40	30	10,9				
370.350.C50.030	New	ISO50	PSC50	50	30	10,9				
370.350.C63.050		ISO50	PSC63	63	50	31				
370.350.C63.080		ISO50	PSC63	63	80	61				

**ART. 370.9..C..  
MAS 403 BT/A-AD**

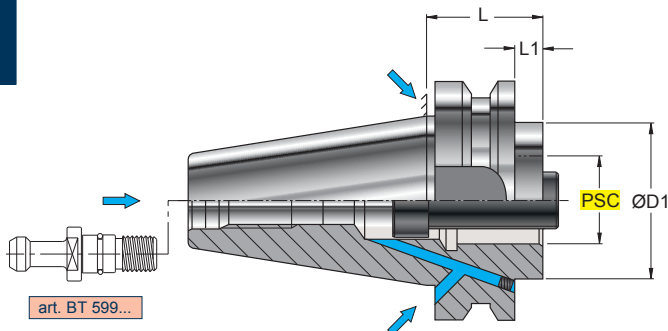

ADATTATORE BASE  
BASIC ADAPTER  
GRUNDAUFNAHMEN  
ADAPTATEUR BASIQUE

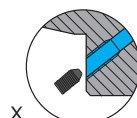

PRE-EQUILBRATO PRE-BALANCED  
G 6,3 8000 min-1

ART.		(mm)								
		PSC	ØD1	L	L1					
370.940.C40.030	New	ISO40	PSC40	40	30	3				
370.950.C50.040	New	ISO50	PSC50	50	40	2				
370.950.C63.050		ISO50	PSC63	63	50	12				
370.950.C63.090		ISO50	PSC63	63	90	52				

**ART. PSC.C..PRL..**  
**ISO 26623-1/A**

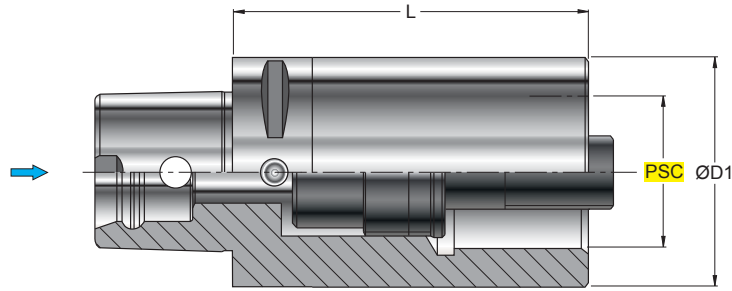

**PROLUNGA**  
EXTENSION  
VERLÄNGERUNG  
RALLONGE

PRE-EQUILIBRATO PRE-BALANCED  
G 6,3 8000 min-1

ART.		(mm)								
		PSC	ØD1	L						
PSC.C40.PRL40.060 <b>New</b>	PSC40	PSC40	40	60						
PSC.C40.PRL40.080 <b>New</b>	PSC40	PSC40	40	80						
PSC.C50.PRL40.080 <b>New</b>	PSC50	PSC50	50	80						
PSC.C63.PRL63.100	PSC63	PSC63	63	100						
PSC.C63.PRL63.140	PSC63	PSC63	63	140						

**ART. PSC.C63.PU..**  
**ISO 26623-1/A**

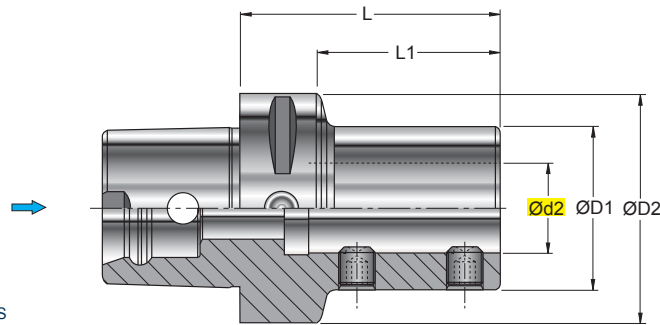

**PORTAPUNTA UNIVERSALE**  
UNIVERSAL ADAPTER FOR DRILLING TOOLS  
WELDON-AUFNAHME FÜR VOLLBOHRER  
PORTE-FORET UNIVERSEL

PRE-EQUILIBRATO PRE-BALANCED  
G 6,3 8000 min-1

ART.		(mm)									
		Ød2	ØD1	ØD2	L	L1					
PSC.C63.PU016.070	PSC63	16	36	63	70	41					
PSC.C63.PU020.070	PSC63	20	40	63	70	42					
PSC.C63.PU025.072	PSC63	25	45	63	72	48					
PSC.C63.PU032.075	PSC63	32	52	63	75	50					

**ART. PSC.C..ER..**  
**ISO 26623-1/A**

PRE-EQUILIBRATO PRE-BALANCED  
G 6,3 8000 min-1

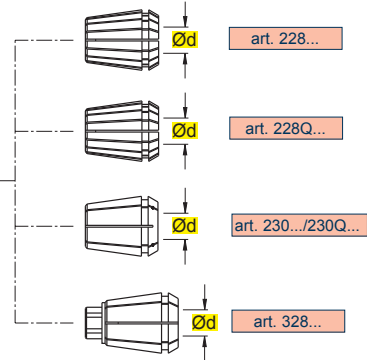
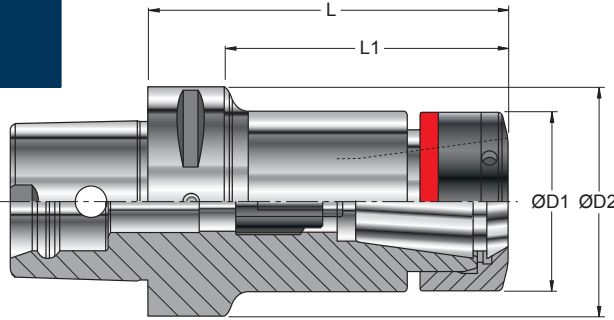

PORTAPINZA STANDARD  
COLLET HOLDER STANDARD  
SPANNFUTTER STANDARD  
MANDRIN PORTE-PINCE STANDARD

ART.		(mm)	Ød	ØD1	ØD2	L	L1						
PSC.C40.ER016.070 <b>New</b>	PSC40	0,5-10	28	40	70	44	--.016.--	RG CER16	925.022				
PSC.C40.ER025.052 <b>New</b>	PSC40	0,5-16	40	40	52	52	--.025.--	RG CER25	925.040				
PSC.C50.ER016.100 <b>New</b>	PSC50	0,5-10	28	50	100	60	--.016.--	RG CER16	925.022				
PSC.C50.ER025.055 <b>New</b>	PSC50	0,5-16	40	50	55	33	--.025.--	RG CER25	925.040				
PSC.C50.ER032.057 <b>New</b>	PSC50	2,5-20	50	50	57	57	--.032.--	RG CER32	925.052				
PSC.C63.ER016.100	PSC63	0,5-10	28	63	100	60	--.016.--	RG CER16	925.022				
PSC.C63.ER025.060	PSC63	0,5-16	40	63	60	33	--.025.--	RG CER25	925.040				
PSC.C63.ER025.100	PSC63	0,5-16	40	63	100	75	--.025.--						
PSC.C63.ER032.060	PSC63	2,5-20	50	63	60	35	--.032.--	RG CER32	925.052				
PSC.C63.ER032.100	PSC63	2,5-20	50	63	100	75	--.032.--						
PSC.C63.ER040.065	PSC63	3-30	63	63	65	65	--.040.--	RG CER40	925.068				
PSC.C63.ER040.130	PSC63	3-30	63	63	130	130	--.040.--						

**ART. PSC.C..FSW..**  
**ISO 26623-1/A**

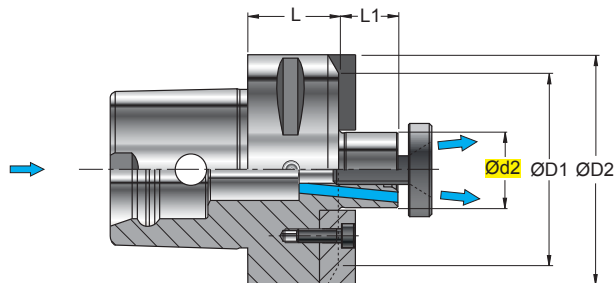

PORTAFRESA A TRASCINAMENTO FRONTALE CON TENONE  
SHELL END-MILL HOLDERS WITH TENON  
FRÄSERAUFNAHME MIT QUERNUT UND LAPPEN  
ADAPTATEUR POUR CONE MORSE AVEC TENON

PRE-EQUILIBRATO PRE-BALANCED  
G 6,3 8000 min-1

ART.		(mm)	Ød2	ØD1	ØD2	L	L1						
PSC.C40.FSW16.032 <b>New</b>	PSC40	16	32	40	32	11							
PSC.C40.FSW22.025 <b>New</b>	PSC40	22	40	40	25	16							
PSC.C50.FSW16.035 <b>New</b>	PSC50	16	32	50	35	11							
PSC.C50.FSW22.025 <b>New</b>	PSC50	22	50	50	25	16							
PSC.C50.FSW27.025 <b>New</b>	PSC50	27	56	50	25	18							
PSC.C50.FSW32.040 <b>New</b>	PSC50	32	63	50	40	20							
PSC.C63.FSW16.040	PSC63	16	32	63	40	11							
PSC.C63.FSW22.025	PSC63	22	55	63	25	16							
PSC.C63.FSW27.025	PSC63	27	63	63	25	18							
PSC.C63.FSW32.025	PSC63	32	63	63	25	20							

**ART. PSC.C..WE..**  
**ISO 26623-1/A**

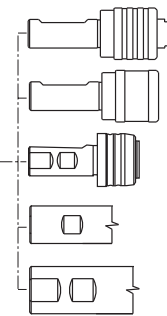
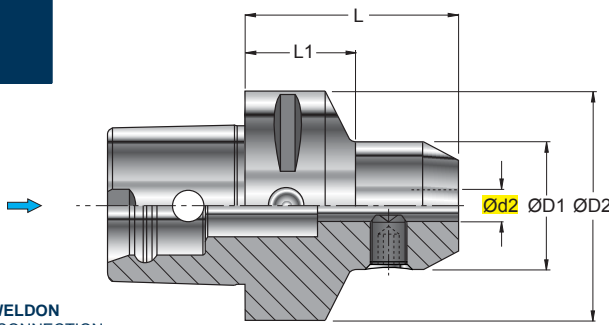

art. CWE..MC..

art. CWE..MR..

art. CWE..MS..

WELDON  
DIN 1835 B  
DIN 6535 HB

PRE-EQUILIBRATO PRE-BALANCED

G 6,3 8000 min-1

**MANDRINO PER ATTACCHI TIPO WELDON**  
END MILL HOLDER FOR WELDON CONNECTION  
WELDON-WERKZEUGAUFNAHME  
MANDRIN POUR ATTACHES TYPE WELDON

ART.		(mm)									
		Ød2	ØD1	ØD2	L	L1					
PSC.C40.WE006.050 <i>New</i>	PSC40	6	25	40	50	25					
PSC.C40.WE008.050 <i>New</i>	PSC40	8	28	40	50	26					
PSC.C40.WE010.051 <i>New</i>	PSC40	10	35	40	51	29					
PSC.C40.WE012.056 <i>New</i>	PSC40	12	42	40	56	36					
PSC.C40.WE016.055 <i>New</i>	PSC40	16	48	40	55	35					
PSC.C50.WE006.050 <i>New</i>	PSC50	6	25	50	50	25,5					
PSC.C50.WE008.050 <i>New</i>	PSC50	8	28	50	50	26					
PSC.C50.WE010.055 <i>New</i>	PSC50	10	35	50	55	27,5					
PSC.C50.WE012.060 <i>New</i>	PSC50	12	42	50	60	36					
PSC.C50.WE016.060 <i>New</i>	PSC50	16	48	50	60	39					
PSC.C50.WE020.060 <i>New</i>	PSC50	20	52	50	60	40					
PSC.C50.WE025.080 <i>New</i>	PSC50	25	64	50	80	60					
PSC.C63.WE006.055	PSC63	6	25	63	55	25					
PSC.C63.WE008.055	PSC63	8	28	63	55	26					
PSC.C63.WE010.060	PSC63	10	35	63	60	30					
PSC.C63.WE012.060	PSC63	12	42	63	60	33					
PSC.C63.WE014.060	PSC63	14	44	63	60	33,5					
PSC.C63.WE016.065	PSC63	16	48	63	65	35,5					
PSC.C63.WE020.065	PSC63	20	52	63	65	37,5					
PSC.C63.WE025.080	PSC63	25	64	63	80	80					
PSC.C63.WE032.090	PSC63	32	72	63	90	90					

**ART. PSC.C..MC..**  
**ISO 26623-1/A**

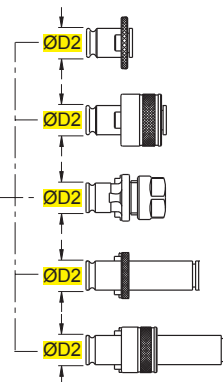
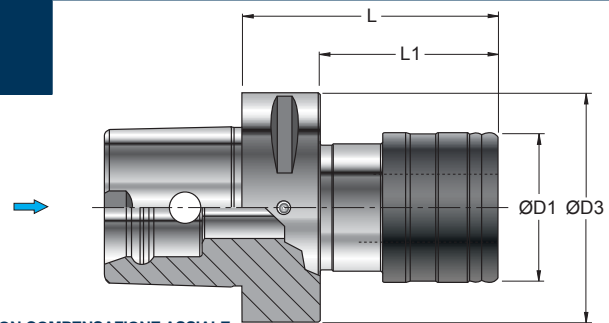

art. 331...

art. 334...

art. 332...

art. 333...

art. 336...

**MASCHIATORI A CAMBIO RAPIDO CON COMPENSAZIONE ASSIALE**  
TAPPING CHUCK WITH AXIAL COMPENSATION  
GEWINDESCHNEIDFUTTER MIT DOPPEL LÄNGENAUSSGLEICH  
APPAREILS À TARAUDER AVEC COMPENSATION AXIALE

ART.		(mm)					Campo di maschiatura Tap range				
		ØD1	ØD2	ØD3	L	L1					
PSC.C40.MC019.068 <i>New</i>	PSC40	41	19	40	68	48	M3-M12				
PSC.C40.MC031.091 <i>New</i>	PSC40	60	31	40	91	71	M8-M24				
PSC.C50.MC019.068 <i>New</i>	PSC50	41	19	50	68	48	M3-M12				
PSC.C50.MC031.091 <i>New</i>	PSC50	60	31	50	91	71	M8-M24				
PSC.C63.MC019.073	PSC63	41	19	63	73	51	M3-M12				
PSC.C63.MC031.097	PSC63	60	31	63	97	75	M8-M24				

**ART. PSC.C..MS..**  
**ISO 26623-1/A**

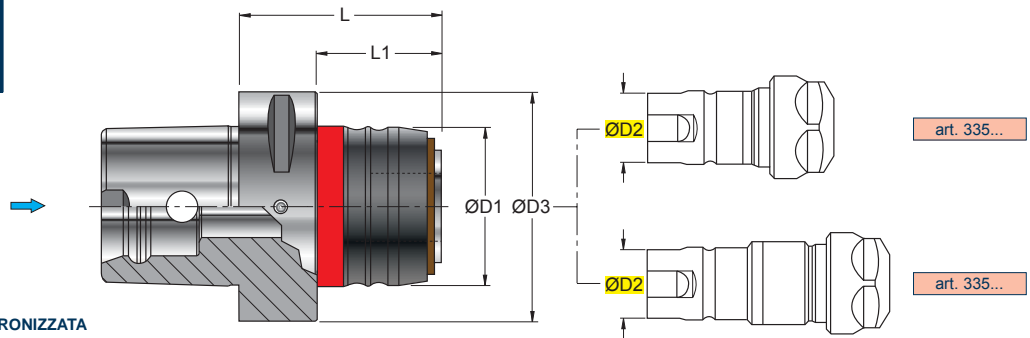

**MASCHIATORI PER MASCHIATURA SINCRONIZZATA**  
TAPPING CHUCKS FOR SYNCRONIZED TAPPING  
GEWINDESCHNEIDER FÜR STARRES GEWINDESCHNEIDEN  
APPAREIL À TARAUDER POUR TARAUDAGE SYNCHRONISÉ

ART.		(mm)					Campo di maschiatura Tap range					
		ØD1	ØD2	ØD3	L	L1						
PSC.C40.MS020.055 <b>New</b>	PSC40	43	20	40	55	35	M3-M12					
PSC.C40.MS032.075 <b>New</b>	PSC40	60	32	40	75	55	M6-M20					
PSC.C50.MS020.055 <b>New</b>	PSC50	43	20	50	55	35	M3-M12					
PSC.C50.MS032.075 <b>New</b>	PSC50	60	32	50	75	55	M6-M20					
PSC.C63.MS020.057	PSC63	43	20	63	57	35	M3-M12					
PSC.C63.MS032.077	PSC63	60	32	63	77	55	M6-M20					

**ART. PSC.C..SF..**  
**ISO 26623-1/A**

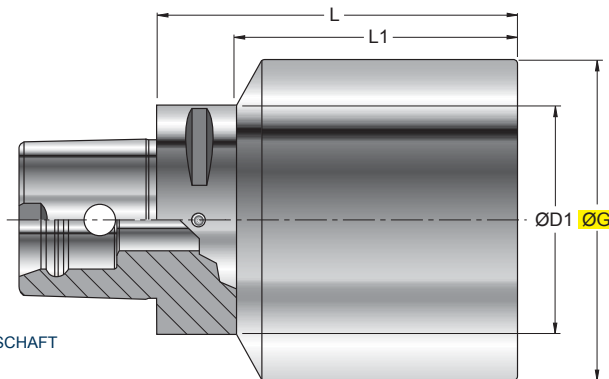

**BARRA CON CONO FINITO E STELO TENERO**  
BORING BARS WITH FINISHED TAPER AND BLANK SCHAFT  
ROHLINGE  
BARRE AVEC CONE FINI ET BOUT DOUX

ART.		(mm)										
		ØG	ØD1	L	L1							
PSC.C40.SF063.165 <b>New</b>	PSC40	63	40	165	145							
PSC.C50.SF050.150 <b>New</b>	PSC50	50	50	150	130							
PSC.C50.SF091.150 <b>New</b>	PSC50	91	50	150	130							
PSC.C63.SF063.180	PSC63	63	63	180	158							
PSC.C63.SF091.075	PSC63	91	63	75	53							
PSC.C63.SF115.100	PSC63	115	63	100	78							

NEW

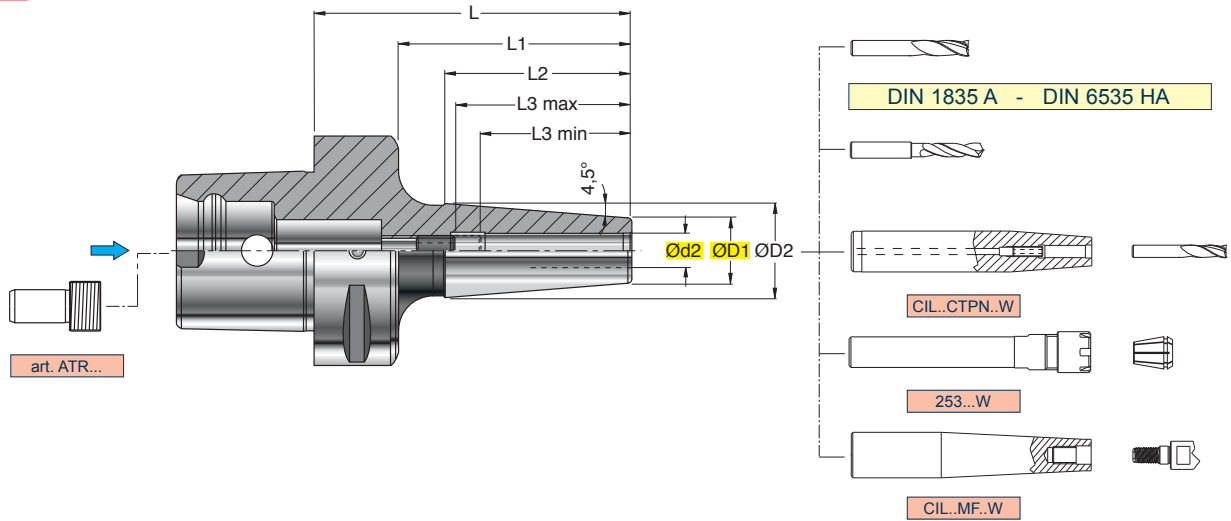

MANDRINO A CALETAMENTO TERMICO  
SHRINKING-ON TAPER SHANKS  
WERKZEUGAUFNAHMEN MIT SCHRUMPFVERBINDUNG  
MANDRIN À EMBOÏTEMENT THERMIQUE

0,003

EQUILIBRATO  
BALANCED  
G 6,3 25000 min-1

ART.	(mm)	Ød2	ØD1	ØD2	L	L1	L2	L3 min	L3 max		
PSC.C63.CTN006.080	PSC63	6	21	27	80	55	-	26	36	GWR 05L	5025
PSC.C63.CTN006.120	PSC63	6	21	27	120	95	-	26	36		
PSC.C63.CTN006.160	PSC63	6	21	27	160	135	100	26	36		
PSC.C63.CTN008.080	PSC63	8	21	27	80	55	-	26	36	GWR 06L	5003
PSC.C63.CTN008.120	PSC63	8	21	27	120	95	-	26	36		
PSC.C63.CTN008.160	PSC63	8	21	27	160	135	100	26	36		
PSC.C63.CTN010.080	PSC63	10	24	32	80	55	-	31	41	GWR 08CTD	5004
PSC.C63.CTN010.120	PSC63	10	24	32	120	95	-	31	41		
PSC.C63.CTN010.160	PSC63	10	24	32	160	135	100	31	41		
PSC.C63.CTN012.085	PSC63	12	24	32	85	60	-	36	46	GWR 10CTD	5005
PSC.C63.CTN012.120	PSC63	12	24	32	120	95	-	36	46		
PSC.C63.CTN012.160	PSC63	12	24	32	160	135	100	36	46		
PSC.C63.CTN014.085	PSC63	14	27	34	85	60	-	36	46		
PSC.C63.CTN014.120	PSC63	14	27	34	120	95	-	36	46		
PSC.C63.CTN014.160	PSC63	14	27	34	160	135	100	36	46		
PSC.C63.CTN016.085	PSC63	16	27	34	85	60	-	39	49	GWR 12CTD	5006
PSC.C63.CTN016.120	PSC63	16	27	34	120	95	-	39	49		
PSC.C63.CTN016.160	PSC63	16	27	34	160	135	100	39	49		
PSC.C63.CTN018.090	PSC63	18	33	42	90	65	-	39	49		
PSC.C63.CTN018.120	PSC63	18	33	42	120	95	-	39	49		
PSC.C63.CTN018.160	PSC63	18	33	42	160	135	100	39	49		
PSC.C63.CTN020.090	PSC63	20	33	42	90	65	-	41	51	GWR 16CTD	5008
PSC.C63.CTN020.120	PSC63	20	33	42	120	95	-	41	51		
PSC.C63.CTN020.160	PSC63	20	33	42	160	135	100	41	51		
PSC.C63.CTN025.120	PSC63	25	44	53	120	95	-	47	57		
PSC.C63.CTN025.160	PSC63	25	44	53	160	135	-	47	57		
PSC.C80.CTN006.080	PSC80	6	21	27	80	50	-	26	36	GWR 05L	5025
PSC.C80.CTN006.120	PSC80	6	21	27	120	90	-	26	36		
PSC.C80.CTN006.160	PSC80	6	21	27	160	130	100	26	36		
PSC.C80.CTN008.080	PSC80	8	21	27	80	50	-	26	36	GWR 06L	5003
PSC.C80.CTN008.120	PSC80	8	21	27	120	90	-	26	36		
PSC.C80.CTN008.160	PSC80	8	21	27	160	130	100	26	36		
PSC.C80.CTN010.090	PSC80	10	24	32	90	60	-	31	41	GWR 08CTD	5004
PSC.C80.CTN010.120	PSC80	10	24	32	120	90	-	31	41		
PSC.C80.CTN010.160	PSC80	10	24	32	160	130	100	31	41		
PSC.C80.CTN012.090	PSC80	12	24	32	90	60	-	36	46	GWR 10CTD	5005
PSC.C80.CTN012.120	PSC80	12	24	32	120	90	-	36	46		
PSC.C80.CTN012.160	PSC80	12	24	32	160	130	100	36	46		
PSC.C80.CTN014.090	PSC80	14	27	34	90	60	-	36	46		
PSC.C80.CTN014.120	PSC80	14	27	34	120	90	-	36	46		
PSC.C80.CTN014.160	PSC80	14	27	34	160	130	100	36	46		
PSC.C80.CTN016.090	PSC80	16	27	34	90	60	-	39	49	GWR 12CTD	5006
PSC.C80.CTN016.120	PSC80	16	27	34	120	90	-	39	49		
PSC.C80.CTN016.160	PSC80	16	27	34	160	130	100	39	49		
PSC.C80.CTN018.095	PSC80	18	33	42	95	65	-	39	49		
PSC.C80.CTN018.120	PSC80	18	33	42	120	90	-	39	49		
PSC.C80.CTN018.160	PSC80	18	33	42	160	130	100	39	49		
PSC.C80.CTN020.095	PSC80	20	33	42	95	65	-	41	51	GWR 16CTD	5008
PSC.C80.CTN020.120	PSC80	20	33	42	120	90	-	41	51		
PSC.C80.CTN020.160	PSC80	20	33	42	160	130	100	41	51		
PSC.C80.CTN025.120	PSC80	25	44	53	120	90	-	47	57		
PSC.C80.CTN025.160	PSC80	25	44	53	160	130	100	47	57		
PSC.C80.CTN032.120	PSC80	32	44	53	120	90	-	51	61		
PSC.C80.CTN032.160	PSC80	32	44	53	160	130	100	51	61		

**ART. PSC.C63.MFS..  
ISO 26623-1/A**

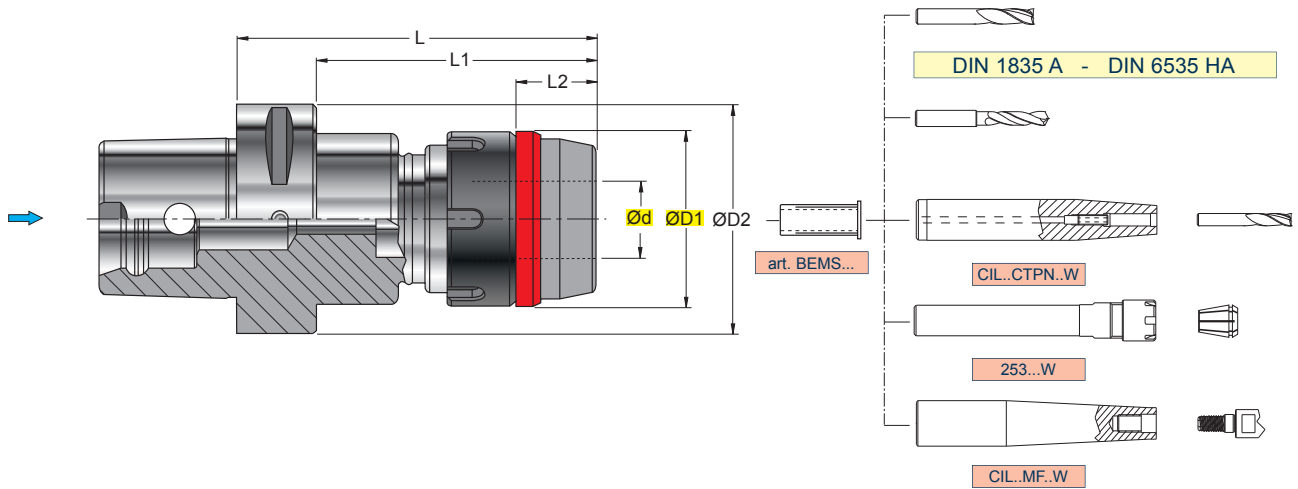

**MANDRINO A FORTE SERRAGGIO**  
HIGH CLAMPING CHUCK  
KRAFTSPANNFUTTER  
MANDRIN À SERRAGE FORT

PRE-EQUILIBRATO PRE-BALANCED  
G 6,3 8000 min-1

ART.		(mm)									
		Ød2	ØD1	ØD2	L	L1	L2				
PSC.C63.MFS016.085	PSC63	16	44	63	85	63	21	-	RGMS016	-	927.039MS
PSC.C63.MFS020.091	PSC63	20	49	63	91	69	23	BEMS.20..	RGMS020	RGMSB020	927.044MS
PSC.C63.MFS032.098	PSC63	32	68	63	98	76	33	-	RGMS032	RGMSB032	927.063MS

PER GLI ANELLI DI TENUTA ANDARE A PAG F 133  
 SEE PAGE F 133 FOR THE SEALING RINGS  
 FÜR DICHTUNGSRINGE AUF SEITE F 133 GEHEN  
 POUR LES BAGUES D'ÉTANCHÉITÉ ALLER PAGE F 133

**CARATTERISTICHE TECNICHE - TECHNICAL CHARACTERISTICS**

- Ridotte dimensioni di ingombro (lunghezza e diametro esterno) che consentono una migliore equilibratura (G 2,5 fino a 20000 rpm)
- Aumento della rigidità del mandrino per una resa migliore in lavorazione
- Perfetta centratura dell'utensile (0,003 mm) che determinano un incremento della durata degli inserti fino a raddoppiare la durata
- Aumento della potenza di serraggio oltre 500 Nm
- Adatto anche per frese con attacco cilindrico, weldon whistle notch e punte in metallo duro
- Possibilità di registrazione assiale della posizione dell'utensile tramite una vite di registrazione a doppio esagono con bloccaggio della posizione scelta
- Passaggio del lubrificante attraverso l'utensile fino a 100 bar

- Reduced dimensions (length and external diameter) for a better balancing (G 2,5 till to 20000 rpm)
- High rigidity of the chuck for a better performance
- Perfect concentricity (0,003 mm) for an increase in toollife
- Increase of tightening force over 500 Nm
- Suitable for endmills tools with cylindrical, weldon and whistle notch shank and for carbide drills
- Axial adjustment of the tools holders through a double hexagon screw with locking on the chosen position
- Coolant through the tool till 100 bar

**ART. PSC.C63.1PA..**  
**ISO 26623-1/A**

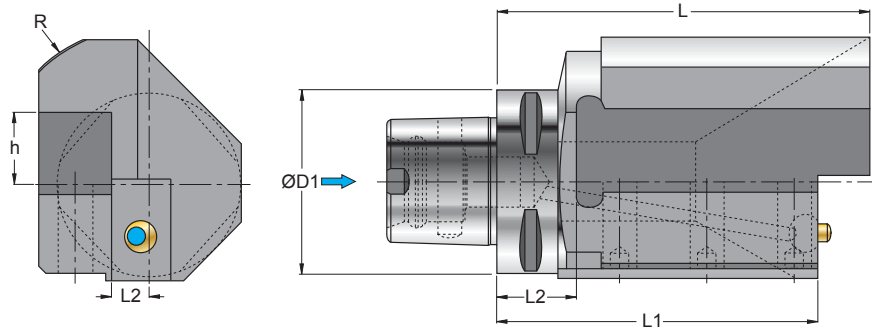

ADATTATORE PER UTENSILI A STELO QUADRO  
ADAPTOR FOR SHANK TOOL  
ADAPTER FÜR SCHAFT WERKZEUGE  
ADAPTATEUR POUR OUTIL À MANCHE

ART.	(mm)												
		ØD1	L	L1	L2	R	f	h					
PSC.C63.1PAL.20.100	PSC63	63	100	90	25	45	10	20					
PSC.C63.1PAR.20.100	PSC63	63	100	90	25	45	10	20					
PSC.C63.1PAL.25.163	PSC63	63	163	112	28	55	13	25					
PSC.C63.1PAR.25.163	PSC63	63	163	112	28	55	13	25					

**ART. PSC.C63.U45..**  
**ISO 26623-1/A**

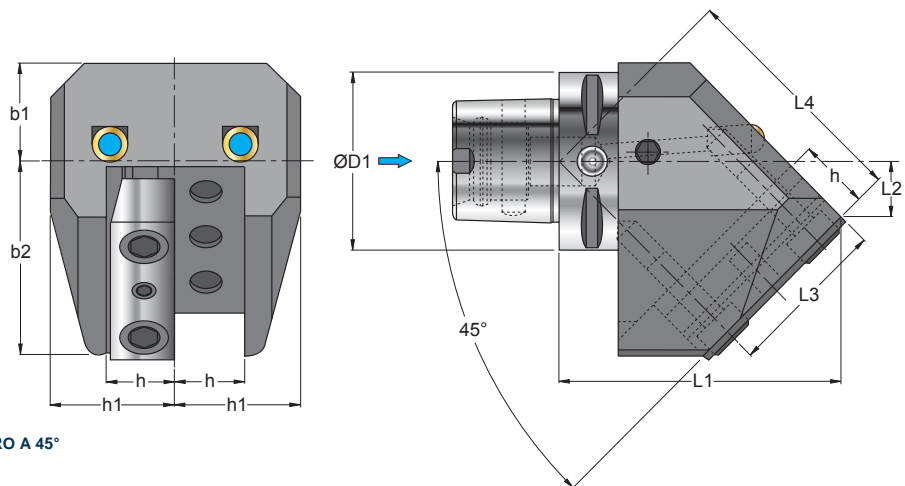

ADATTATORE PER UTENSILI A STELO QUADRO A 45°  
ADAPTOR FOR SHANK TOOL 45°  
ADAPTER FÜR SCHAFT WERKZEUGE 45°  
ADAPTATEUR POUR OUTIL À MANCHE 45°

ART.	(mm)													
		ØD1	b1	b2	h	h1	L1	L2	L3	L4				
PSC.C63.U45.25102	PSC63	63	35	70	25	45	102	20	58	86				