

# БЫСТРОСМЕННЫЕ СВЕРЛИЛЬНЫЕ/ РЕЗЬБОНАРЕЗНЫЕ (ЦАНГОВЫЕ) ПАТРОНЫ DC

DC Quick change drilling chuck  
DC 快換式刀柄本體

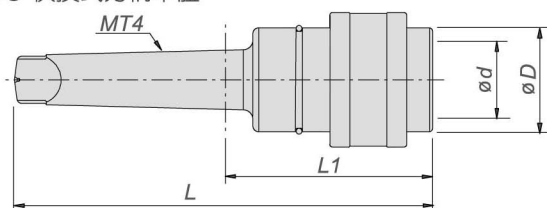

Fig.1

DC Drilling chuck  
DC 鑽夾頭

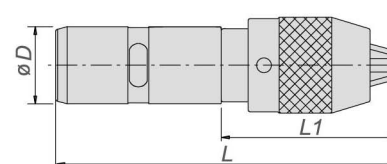

Fig.2

DC Drilling selves  
DC 鑽頭套筒

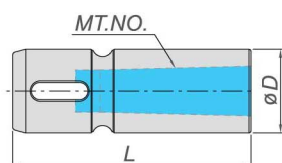

Fig.3

DC Tapping chucks  
DC 攻牙夾頭

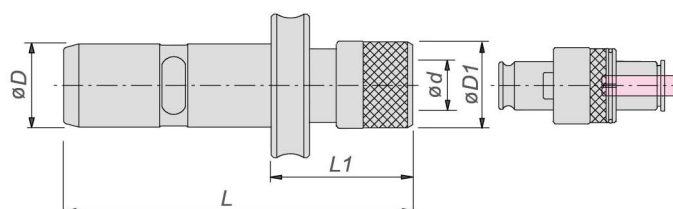

Fig.4



Part No. 規格	Fig.	ød	øD	øD1	L	L1	MT. NO. 内錐孔	Chuck 夾頭
<b>DC-MT4</b>	1	40	54	-	218	100	-	-
<b>DC-APU13</b>	2	-	40	-	179	93	-	APU13
<b>DC-APU16</b>								APU16
<b>DC-MT1</b>	3	-	40	-	81	-	MT1	-
<b>DC-MT2</b>					94		MT2	
<b>DC-MT3</b>					114		MT3	
<b>DC-MT4</b>					140		MT4	
<b>DC-SF12</b>	4	19	40	34	136	55	-	TC312L
<b>DC-SF20</b>		31		50	150	69		TC820L